



***7151.1000***

**R600**

Onderdelen informatie  
Erzatzteil information  
Spare part information  
Information de pièces





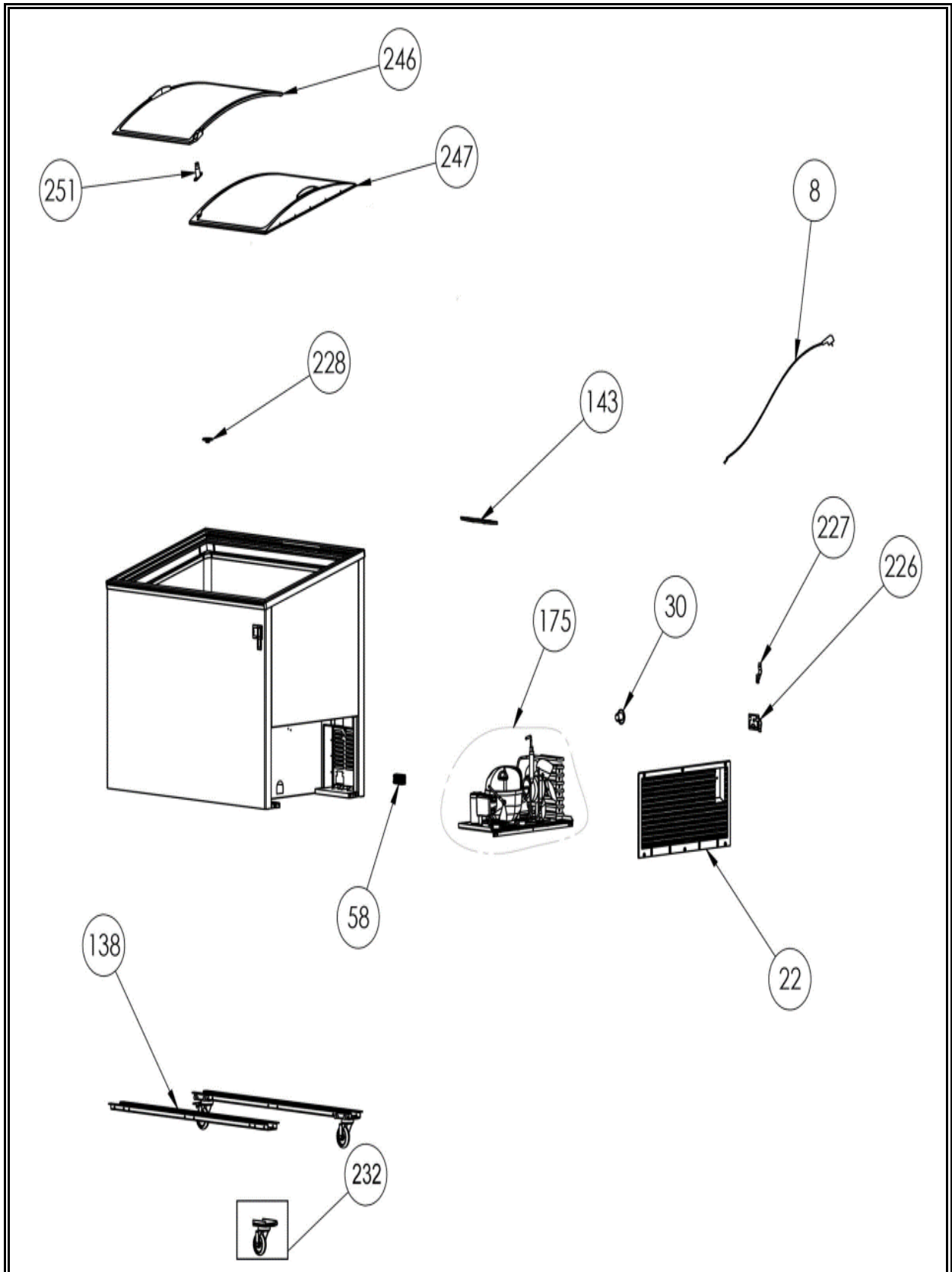

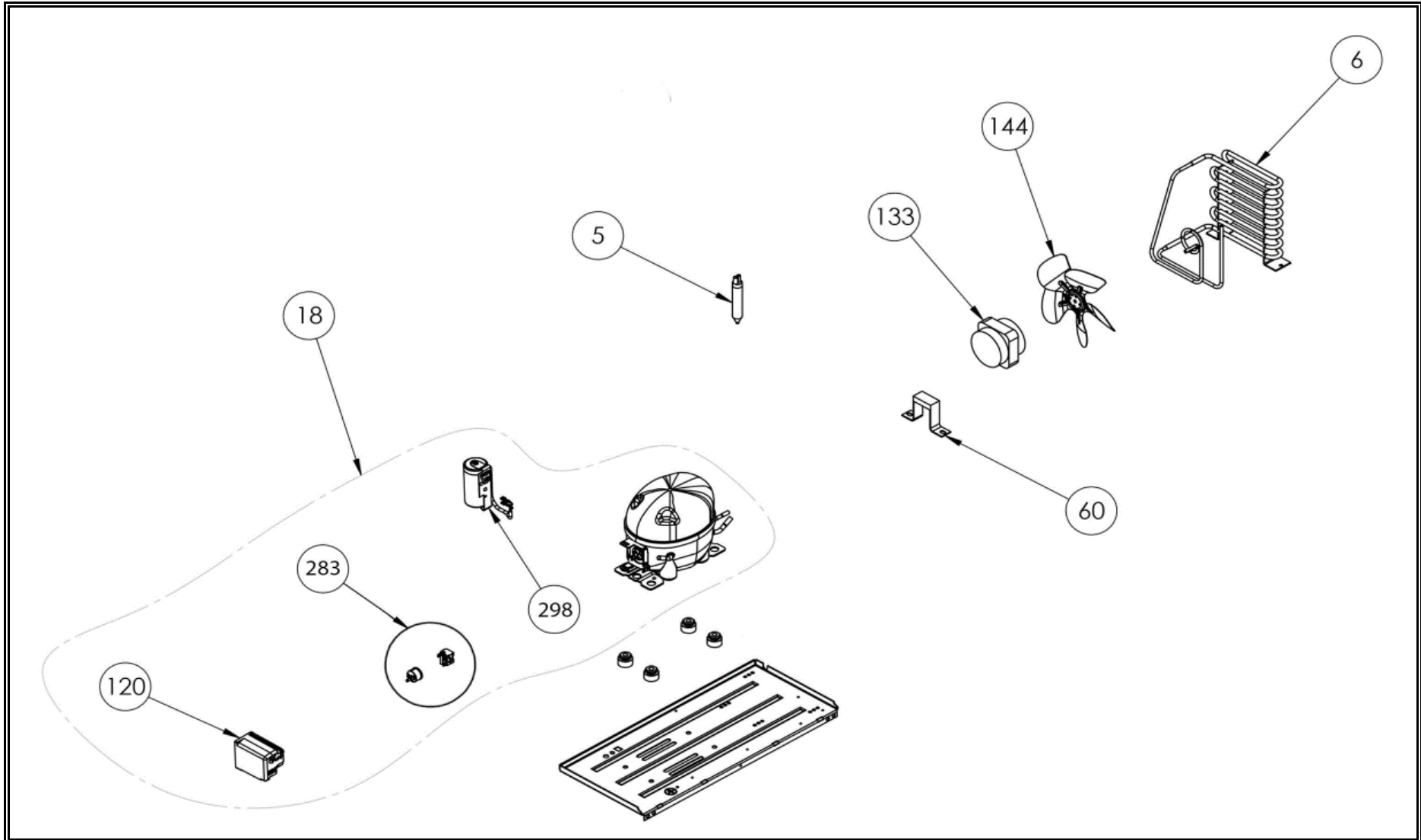

POS:	Art.No.:	Omschrijving:	Aantal:
5	CS9338.4154	DRYER 15 GR (6,1mm x 4,1mm)	1
6	CS9338.4150	CONDENSER DD 2 SIRA (210 CABINET)	1
8	CS9338.4144	PLUG CABLE 3000MM 3G1 SKN C2 (EU)	1
13		POT KNOB MECH.	1
18	CS9338.4130	D200 KOMP. PAKETI (TT1117GY-CUBIGEL-R600a) (CERCEVE ISITICI)	1
20		SERVICE PIPE (V TYPE 6MM)	1
31		MTL CABLE HOLDER (10)	1
31		PLASTIC CABLE HOLDER (8)	1
32		ICE SCRAPER	1
35		PIPE DRYER VACUUM(6MM)	1
58	CS9338.4143	THERMOSTAT FOSHAN KPF39-E DONDURMA DOL. EXPROOF	1
60		MTL. FAN HOLDER H55	1
67		HINGE WASHER	0,094
119		TERMINAL HOUSING SF23D RPK 4,8*0,8	3
119		TERMINAL HOUSING SF23D RPK 4,8*0,8	2
119		TERMINAL SF1DE RPK 4,8	1
119		TERMINAL SKN1	1
119		TERMINAL SF23D RPK 6,3X0,8	3
133	CS9338.4142	MOTOR EXTERNAL FAN WEIGUANG (YZF7-20 220-240 V 50/60Hz)	1
138		ROLLER FIXING SHEET 30MM U TABLA 210	2
143		DD SLID. GLASS SUPPORT PART	6
209		ALU. FAN BLADE Ø200 34° EMME	1
228	CS9338.4146	DRAIN TUBE CAP (7042)	1
228		D550 DRAIN TUBE CAP EXTER.(7042) SILVER	1
246		D200 UPPER CURVED ENCAPS GLASS ASSEMB..	1
247		D200 CURVE ENCAPS BOTTOM GLASS ASSEMB..	1
250		DD LOCK ASSEMBLY CURVE ENCAPS	1
1123		PLAST. EXCHANGER CONTACT BARRIER	7
232	CS7151.9010	Wheelset 7151.1000-1005	1
A	CS7151.9000	Mand 7151.1XXX	